

NAUTILIGHT
NAVI

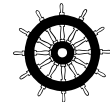

LED NAVIGATION LIGHT

NLL Series



JAPAN TYPE
APPROVAL

GOOD
DESIGN

www.nautilight.jp

Made in Japan

TOUCH THE NEXT STANDARD

NAUTILIGHT NAVI

NAUTILIGHT NAVI is a new LED navigation light brand. As vessels become more technologically sophisticated and the maritime industry more safety-focused, the marine equipment must change as well. The NLL series is a revolutionary new design developed to meet next generation standards and a completely fresh approach to the navigation light.

NAUTILIGHT
NAVI



DESIGN FROM ZERO

Starting from scratch

To develop this new brand we went back to basics and carefully rethought the concept of the navigation light. Starting from scratch, we abandoned all preconceived notions of what a navigation light should be; the only condition that the light source be an LED.

All the components in this light have been newly designed to produce ideal light distribution. To improve safety we have created a self-monitoring system for the LED bulb, while the light features a variety of other innovative technologies such as a specially-developed socket system. This brand new navigation light has an advanced yet uncomplicated design based on the skillful fitting together of a range of new functions.

All developed completely from scratch.



TECHNOLOGICAL INNOVATION

Revolutionary technology to control light distribution

There is full of technology into the Nautilight Navi.

Light control technology is one of the key factor of LED navigation light.

We develop the components to control the light lux,angle and brightness.

At last,perfect light control enable to emit light free from inboard black screen.

IBUKI navigation light will expand the new idea on ship's design.





TECHNOLOGICAL INNOVATION

An intelligent navigation light

LEDs do not last forever and due to combinations of unforeseen circumstances LED bulbs may break. In order to ensure continuous and safe navigation it is vital that any problem is accurately detected and the crew informed. For that reason the LED unit includes smart technology. Our newly-developed LED bulb monitoring system (LBDS) continually checks for any problem with internal parts and monitors the life span of the bulb itself. It will quickly detect any malfunction, and by turning the light off accurately transmit to the navigation light control panel. A specially-developed socket system allows expired bulbs to be replaced at a touch. In this new design, we have retained the merits of existing systems and incorporated only the advantages of LEDs. In other words, switching to LED needs no trade-off of any kind.

ROUND-THE-CLOCK LOGISTICS

A parts supply network spanning the globe

Marine transportation is the backbone of global logistics, so it is absolutely important that any issues with navigation equipment do not affect shipping schedules. It is also essential that the equipment on board ships has as few problems as possible, and that any problems that do occur are swiftly resolved.

We have specially developed a new socket system so that, on the rare occasions when a light malfunctions, the LED bulb can be replaced at a touch. As soon as the bulb is replaced the light will be as bright as when brand new. And if a onboard spare bulb runs out they can be acquired at ports all over the world via our globe-spanning parts supply network. Lastly, the LED bulb's lifespan is 40,000 hours, so bulbs can be replaced during routine inspection and there is no need to replace them while at sea.



NAUTILIGHT
NAVI

NLL Series Line-Up

NAVIGATION LIGHT DOUBLE DECK TYPE



MAST HEAD LIGHT
NLLM-1WD



SIDE LIGHT (RED)
NLLG-1RD



SIDE LIGHT (GREEN)
NLLG-1GD



STERN LIGHT
NLLS-1WD

SIGNAL LIGHT



ALL ROUND LIGHT
NLLA-1WD



ALL ROUND LIGHT
NLLA-1RD



MANOEUVRING LIGHT
NLLA-ML

NAVIGATION LIGHT



MAST HEAD LIGHT
NLLM-1W



SIDE LIGHT (RED)
NLLG-1R



SIDE LIGHT (GREEN)
NLLG-1G



STERN LIGHT
NLLS-1W



ALL ROUND LIGHT
NLLA-1W



ALL ROUND LIGHT
NLLA-1R



ALL ROUND LIGHT
NLLA-1G



TOWING LIGHT
NLLT-1Y

FLASHING LIGHT



FLASHING LIGHT
NLLF-1R 130/min



FLASHING LIGHT
NLLF-2R 190/min



FLASHING LIGHT
NLLF-1G 130/min



FLASHING LIGHT
NLLF-2G 190/min

Spare Parts

LED BULB



LW-200 (WHITE)
For 5-6 Nm



LW-100 (WHITE)
For 3Nm



LR-100 (RED)
For 3Nm



LG-100 (GREEN)
For 3Nm



LRF-1/2 (RED)
For Flashing light



LGF-1/2 (GREEN)
For Flashing light



REPAIR KIT

Spec & Outline

Specifications of LED Navigation Lihgt NLL Series			
LED Bulb	LW-200	(WHITE)	5-6 Nautical Miles
	LW-100	(WHITE)	3 Nautical Miles
	LR -100	(RED)	
	LG -100	(GREEN)	
	LRF-1/LRF-2	(RED)	For Flashing Light
	LGF-1	(GREEN)	
Source Voltage	AC100-110V/220-230V		
	DC24V		
Consumption	Approx. 12W		
Life of LED Bulb	40000 Hours		
Failure Alarm	Current Sense		
Applied Rules	Performance Standard	MSC253	IEC14744
	Environmental Standard	IEC60945	IEC14744
	EMC	IEC60945	IEC61000
Type Approval	MED	JG	
Dimension	Shown drawings		
Mass	Approx. 2.5kg		

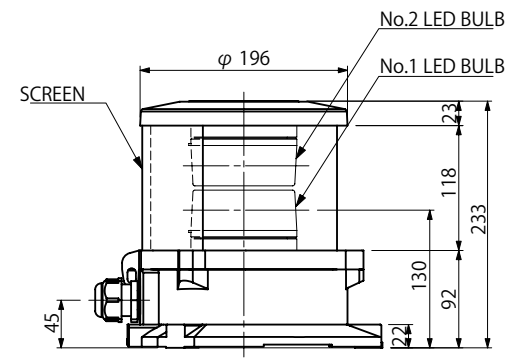
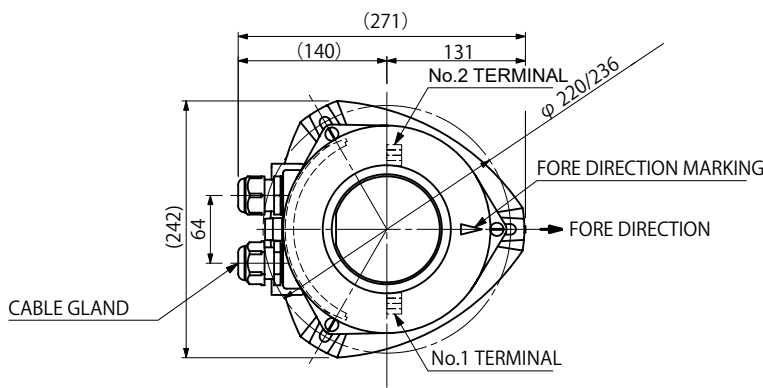

Global Parts Supply Network



Produced by
IBUKI KOGYO CO., LTD.

Head Office (Osaka)
〒 535-0031 7-28 Takadono 1-chome ,Asahi-ku ,Osaka JAPAN
TEL +81-6-6922-5115 FAX +81-6-6924-3567
E—Mail ibukimk@ibukikogyo.co.jp

Tokyo Branch
〒 101-0041 1-22 Suda-cho ,Kanda,Chiyoda-ku Tokyo JAPAN
TEL +81-3-3251-4153 FAX +81-3-3251-4158
E—Mail ibukitko@ibukikogyo.co.jp

- JAPAN
 - Osaka (Head Office)
 - Tokyo
- U.S.A.
 - New Jersey
 - Baltimore
 - Houston
- U.K.
 - London
- Greece
 - Piraeus
- Holland
 - Rotterdam
- Denmark
 - Copenhagen
- Norway
 - Trondheim
- Spain
 - Vigo
- U.A.E.
 - Dubai
 - Abu Dhabi
- Oman
- India
 - Mumbai
 - Visakhapatnam
- Singapore
- China
 - Shanghai
 - Dalian
 - Qingdao
- Taiwan R.O.C.
- Philippines
 - Manila
- Korea
 - Seoul
 - Busan
- Australia
 - Perth
 - Tasmania
- Brazil
 - Rio De Janeiro

NAUTILIGHT
NAVI

www.nautilight.jp